

THIS DOCUMENT PROPRIETARY TO TITAN AIRCRAFT, AND IS NOT TO BE USED, CIRCULATED, REPRODUCED, COPIED, OR DISCLOSED IN ANY MANNER WITHOUT PRIOR WRITTEN PERMISSION OF AN AUTHORIZED OFFICIAL OF TITAN AIRCRAFT.

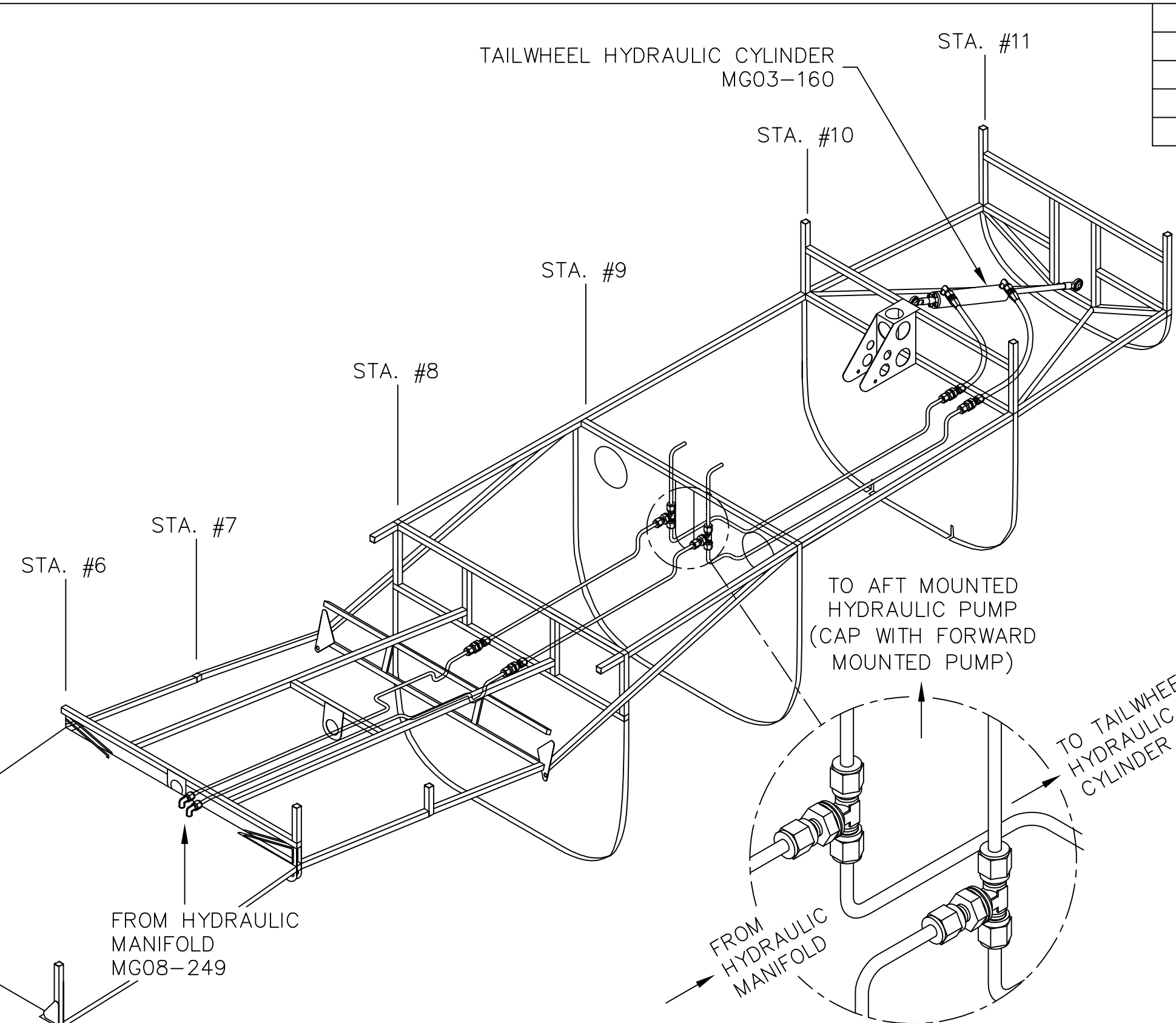

REVISIONS				
E.C. NO.	REV.	DESCRIPTION	BY	DATE
0321	C	NOTES ADDED	SH	8/06
1081	D	UPDATED DRAWING	BH	7/10
1152	E	UPDATED DRAWING	BH	1/13

**NOTES:**

- REFER TO DRAWING T51-04-INS-1002 TO MOUNT THE TAILWHEEL HYDRAULIC CYLINDER (MG03-160) BETWEEN STATIONS 10 & 11.
- REFER TO DRAWING T51-04-INS-0994 FOR MAIN LANDING GEAR HYDRAULIC LINE INSTRUCTIONAL.
- REFER TO DRAWING T51-06-INS-1520 FOR THE FORWARD PARKER HANNIFIN HYDRAULIC PUMP INSTALLATION & T51-06-INS-1521 FOR THE AFT INSTALLATION.
- REFER TO DRAWING T51-07-INS-1651 FOR LANDING GEAR SCHEMATIC FOR PARKER HANNIFIN PUMP.
- RUN TWO LINES FROM THE HYDRAULIC MANIFOLD (MG08-249) ALONG THE COCKPIT FLOOR, UNDER THE CROSS TUBE, AND THROUGH BULKHEADS #8, #9, AND #10. CONNECT TO THE TAILWHEEL HYDRAULIC CYLINDER WITH STAINLESS STEEL BRAIDED LINES.
- USE AN960-716 WASHERS ON EITHER SIDE OF THE BULKHEAD FITTINGS.
- IF YOU INSTALLED THE HYDRAULIC PUMP IN THE FORWARD FUSELAGE, YOU WILL NEED TO CAP THE TOP OPENING OF THE BULKHEAD TEES AT STATION #9.
- THIS HYDRAULIC LAYOUT IS FOR SERIAL #180 & LATER MODELS OF AIRCRAFT.

**TITAN AIRCRAFT SUPPLY**  
 1419 STATE ROUTE 45 SOUTH  
 AUSTINBURG, OHIO 44010

DETAIL NAME TAILWHEEL HYDRAULIC LINE INSTRUCTIONAL		SCALE N/A	PART NO.
DRAWN C. EMERY		DATE 1/06/04	
CHECKED K. BROOKS		DATE 1/17/13	
APPROVED B. KOLENO		DATE 2/18/13	
ASSEMBLY NAME		DRAWING NO. H8	
DRAWING NO. <b>B T51-04-INS-0993-E</b>			