

THIS DOCUMENT PROPRIETARY TO TITAN AIRCRAFT, AND IS NOT TO BE USED, CIRCULATED, REPRODUCED, COPIED, OR DISCLOSED IN ANY MANNER WITHOUT PRIOR WRITTEN PERMISSION OF AN AUTHORIZED OFFICIAL OF TITAN AIRCRAFT.

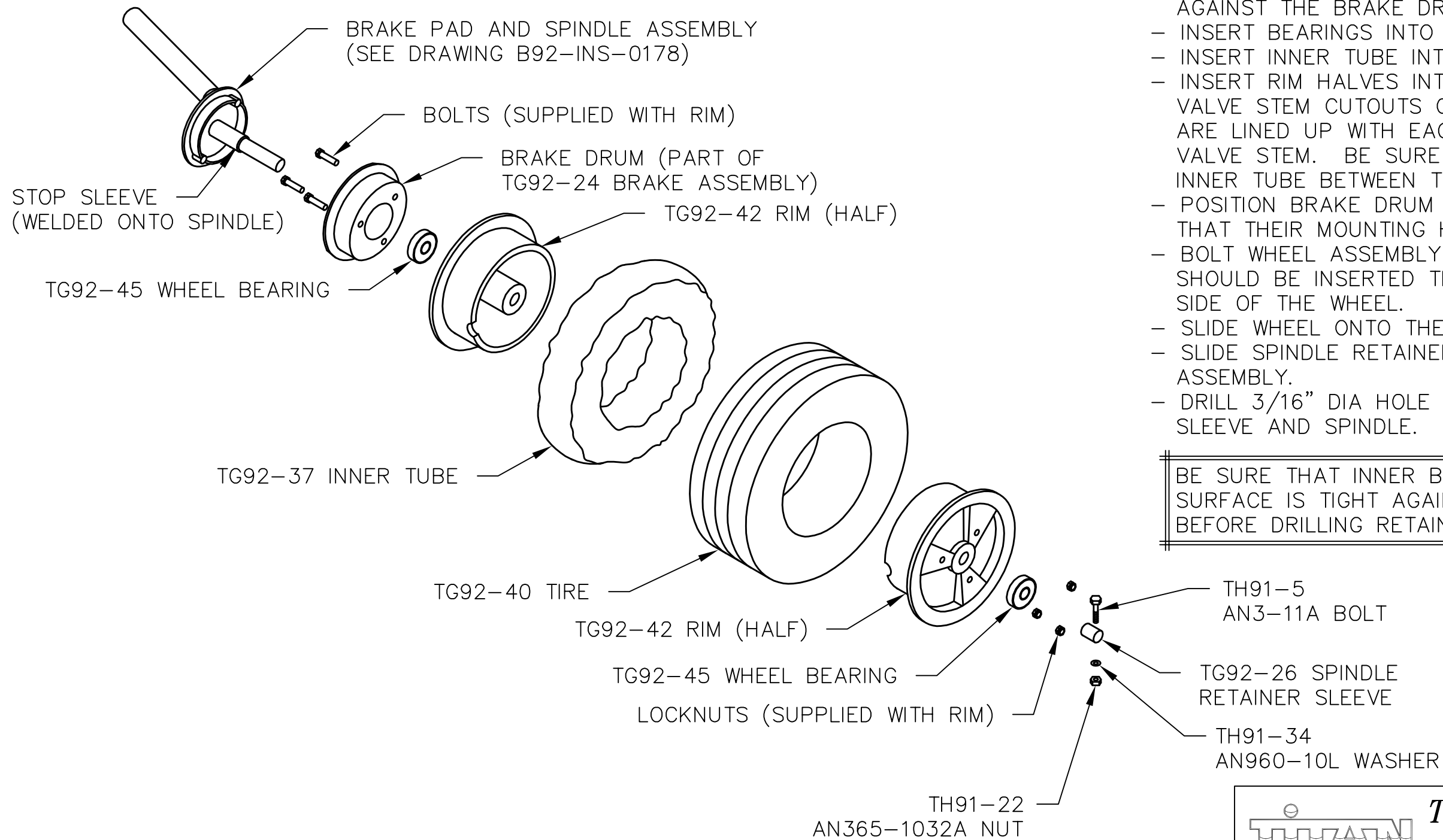

ASSEMBLY NOTES:

- BRAKE PADS MAY NEED TO BE SANDED DOWN SLIGHTLY SO THEY DO NOT RUB AGAINST THE BRAKE DRUM.
- INSERT BEARINGS INTO BOTH RIM HALVES.
- INSERT INNER TUBE INTO TIRE.
- INSERT RIM HALVES INTO TIRE. ENSURE THE VALVE STEM CUTOUTS ON BOTH RIM HALVES ARE LINED UP WITH EACH OTHER AND THE VALVE STEM. BE SURE NOT PINCH THE INNER TUBE BETWEEN THE RIM HALVES.
- POSITION BRAKE DRUM ON A RIM HALF SO THAT THEIR MOUNTING HOLES ARE IN LINE.
- BOLT WHEEL ASSEMBLY TOGETHER. THE BOLTS SHOULD BE INSERTED THRU THE BRAKE DRUM SIDE OF THE WHEEL.
- SLIDE WHEEL ONTO THE SPINDLE ASSEMBLY.
- SLIDE SPINDLE RETAINER SLEEVE ONTO SPINDLE ASSEMBLY.
- DRILL 3/16" DIA HOLE THRU SPINDLE RETAINER SLEEVE AND SPINDLE. INSERT AN3-11A BOLT.

BE SURE THAT INNER BEARING ON WHEEL SURFACE IS TIGHT AGAINST STOP SLEEVE BEFORE DRILLING RETAINER SLEEVE.

	<p>TITAN AIRCRAFT SUPPLY 1419 STATE ROUTE 45 SOUTH AUSTINBURG, OHIO 44010</p>
---	--

DETAIL NAME		LANDING GEAR INSTALLATION	
DRAWN	DATE	SCALE	PART NO.
J. PRESTON	12/23/92	N/A	
CHECKED		ASSEMBLY NAME	
B. PASSAFIUME	DATE	PART NO.	DRAWING NO.
	8/17/93		
APPROVED		DRAWING NO.	
J. WILLIAMS	DATE	B 92-INS-0331-B	
	8/17/93		