

REVISIONS

E.C. NO.	REV.	DESCRIPTION	BY	DATE
1086	B	INSTALLATION IS BOLTED	K.B.	6/97
1846	C	ADDED PART NUMBERS	KL	3/01

ASSEMBLY NOTES:

- INSERT BEARING INTO BOTH RIM HALVES.
- INSERT INNER TUBE INTO TIRE.
- INSERT RIM HALVES INTO TIRE. ENSURE THE VALVE STEM HOLES LINE UP WITH EACH OTHER AND THE VALVE STEM. BE SURE THE INNER TUBE IS NOT PINCHED BETWEEN THE RIM HALVES.
- BOLT WHEEL ASSEMBLY TOGETHER.
- INSERT WHEEL ASSEMBLY INTO NOSE FORK.
- POSITION NOSEWHEEL SPACERS BETWEEN THE WHEEL ASSEMBLY AND NOSE FORK.
- SLIDE AXLE THRU NOSE FORK, NOSEWHEEL SPACERS, AND WHEEL ASSEMBLY.
- CENTER ENTIRE ASSEMBLY ON AXLE. DRILL A 3/16(.1875 DIA.) HOLE THRU EACH SIDE KNUCKLE AND AXLE. BOLT WITH AN3-11A BOLT, AN365-1032 NYLON LOCK NUT AND AN960-10 WASHER.

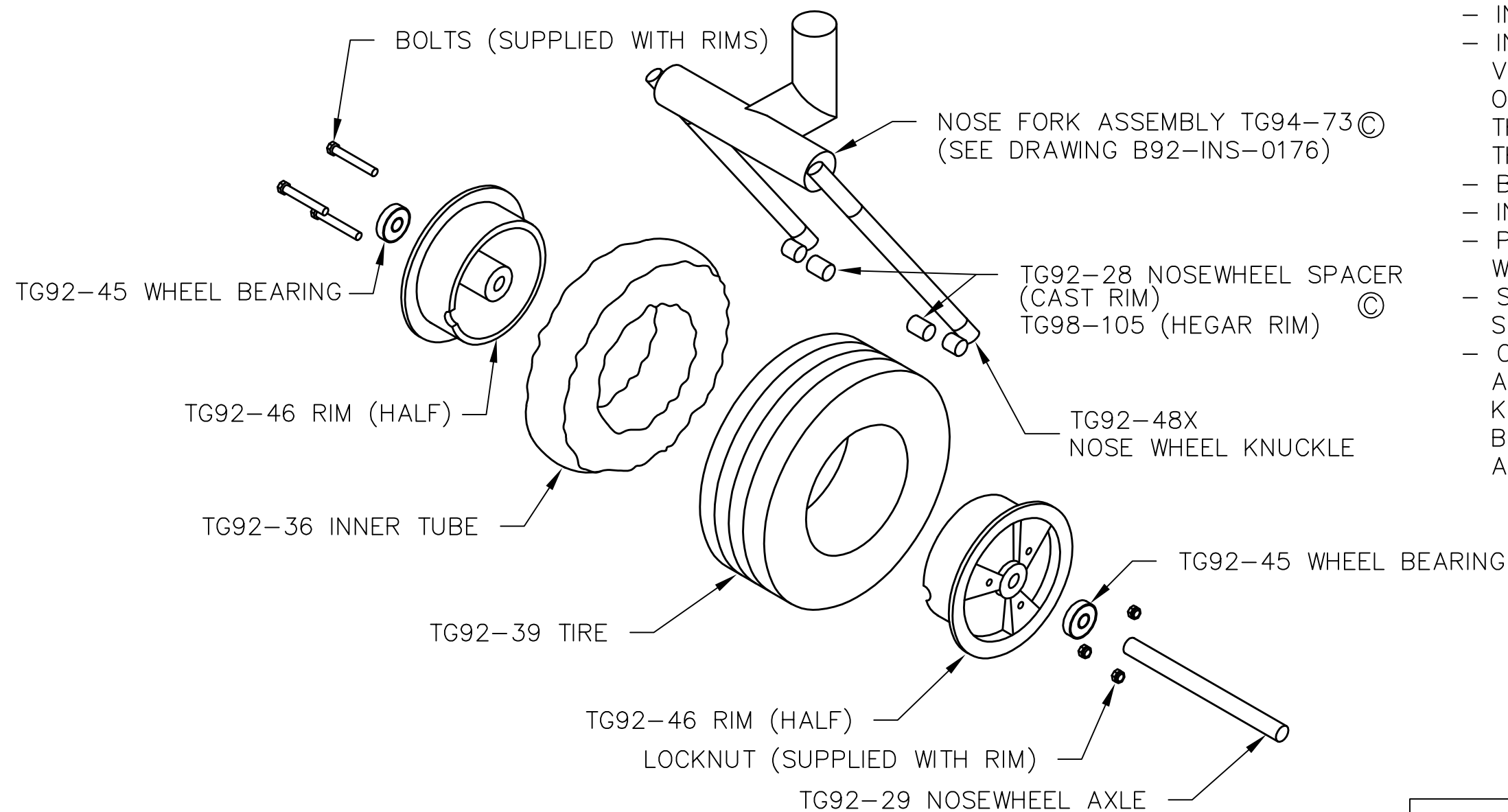

TITAN AIRCRAFT SUPPLY
 1419 STATE ROUTE 45 SOUTH
 AUSTINBURG, OHIO 44010

DETAIL NAME		NOSEWHEEL INSTALLATION	
SCALE	N/A	PART NO.	
ASSEMBLY NAME ALL TORNADO AIRCRAFT			
PART NO.	N/A	DRAWING NO.	
DRAWING NO.		B 92-INS-0332-C	

DRAWN	J. PRESTON	DATE	12/23/92
CHECKED	R. INGLE	DATE	3/5/01
APPROVED	J. WILLIAMS	DATE	3/5/01

THIS DOCUMENT PROPRIETARY TO TITAN AIRCRAFT. AND IS NOT TO BE USED, CIRCULATED, REPRODUCED, COPIED, OR DISCLOSED IN ANY MANNER WITHOUT PRIOR WRITTEN PERMISSION OF AN AUTHORIZED OFFICIAL OF TITAN AIRCRAFT.